



QUARTER-TURN VIBRATION RESISTANT 18 MM

Vibration-resistant quarter-turn latch for use in railway applications with DB (Deutsche Bahn) standard insert. The fastener is vibration-resistant to prevent unintentional opening.

Protection degree according to IP66 and waterproof according to NEMA 4 are achieved by using an O-ring on the insert and a flat gasket on the housing.

Universal clockwise or counterclockwise rotation when opening and closing.



MATERIAL

Cam: Steel, zinc plated

Housing: Zinc die cast, chrome plated or black texture powder coated

Insert: Zinc die cast, chrome plated or black texture powder coated

Nut: Zinc die cast, zinc plated

RELATED PRODUCTS

Other materials: 6-134a

Similar products: 2-020

Cams: 2-481, 2-491

Use the Index Code at industrilas.com

TECHNICAL INFORMATION

Standards: IP66, NEMA 4, DIN EN 61373

Cutout: COMBI

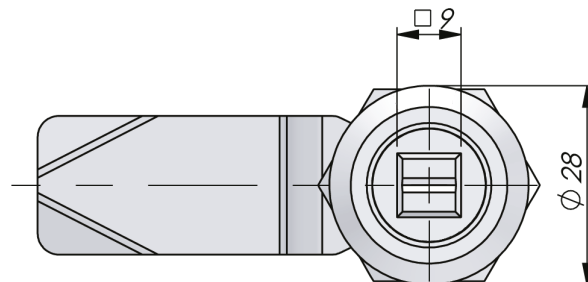
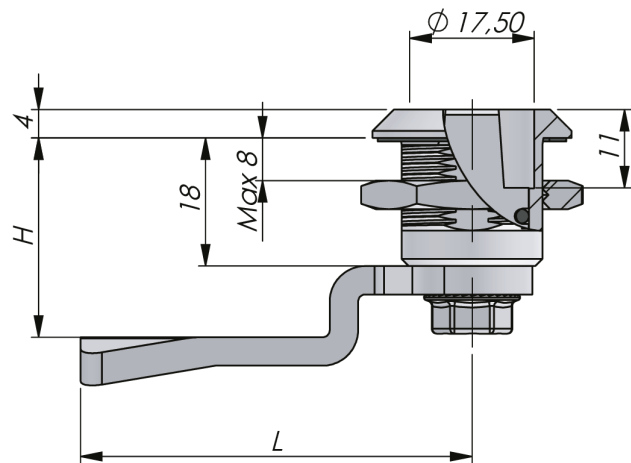

Industrilas
— When access counts —

Make your selections in each column to create your article number (AAAA-BCCDEF-HLL)

AAAA Housing	B Nut	CC Insert	D Surface	E Assembly IP66	F Cam	HLL H/L in mm
2412 Zinc, chrome plated A=28, B=4	2 SN+TUF	30 DB - Deutsche Bahn	2 Chrome	0 IP54 - Not assembled	0 Steel	0000 No cam
2416 Zinc, black coated A=28, B=4	4 EN+TUF		6 Black Powder Coated	1 IP66 - not assembled		0445 4 / 45
				2 IP54 - enclosed cam		0645 6 / 45
				3 IP66 - enclosed cam		0845 8 / 45
				4 IP54 - assembled		1045 10 / 45
				5 IP66 - assembled		1245 12 / 45
				6 IP66 PUR - not assembled		1445 14 / 45
				7 IP66 PUR - enclosed cam		1645 16 / 45
				8 IP66 PUR - assembled		1845 18 / 45
						2045 20 / 45
						2245 22 / 45
						2445 24 / 45
						2645 26 / 45
						2845 28 / 45
						3045 30 / 45
						3245 32 / 45
						3445 34 / 45
						3645 36 / 45
						3845 38 / 45
						4045 40 / 45
						4245 42 / 45
						4445 44 / 45
						4645 46 / 45
						4845 48 / 45
						5045 50 / 45

SN = Standard nut. EN = Earthing nut.

TUF = Assembled with TUF-loc to achieve DIN EN 61373.

